

TECHNICAL DATA

RELEASED:13/09/2024
 REVISED:
 REV: 00

1VM Ex PNEUMATIC VANE MOTOR

DIMENSIONAL DATA - HUB MOUNTING 1VM

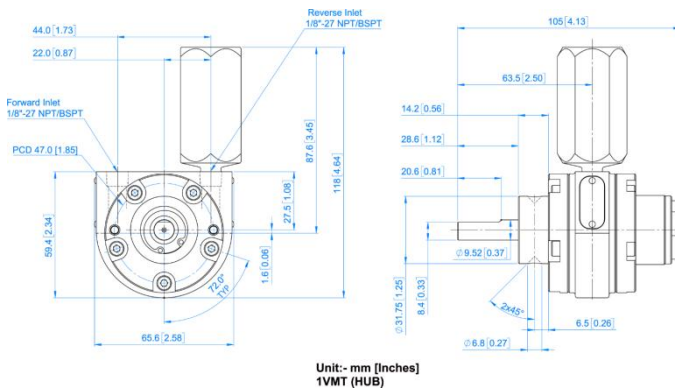

DIMENSIONAL DATA - FOOT MOUNTING 1VM

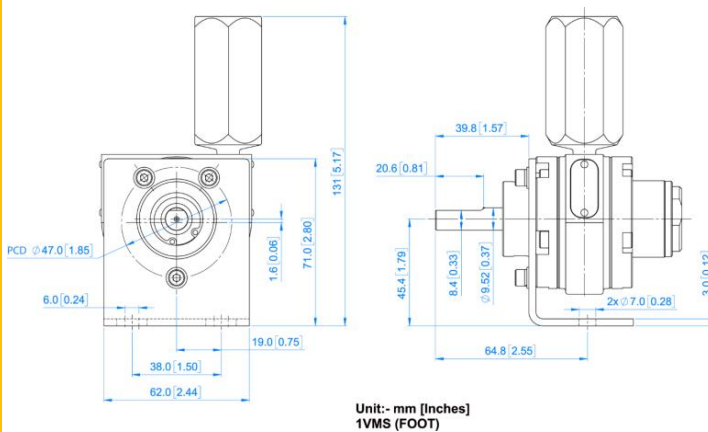

PERFORMANCE DATA

Max Output Power	0.33kW (0.45hp)
Speed at Max Power	10000 RPM
Maximum Torque	0.65Nm (5.75lb-In)
Air Consumption at Max Power	35.1m3/hr (20.5cfm)
Ambient Safe Operating Temperature	
• Non Explosive Zone	0°C to 120°C
• Explosive Zone	0°C to 40°C
Maximum Allowable Operating Speed In any Direction	10000 RPM
Working Pressure	7kg/cm ² (100 psi)

POWER & TORQUE GRAPH

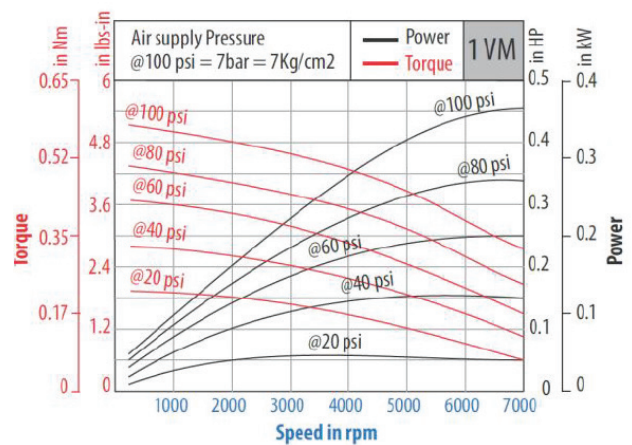

AIR CONSUMPTION GRAPH

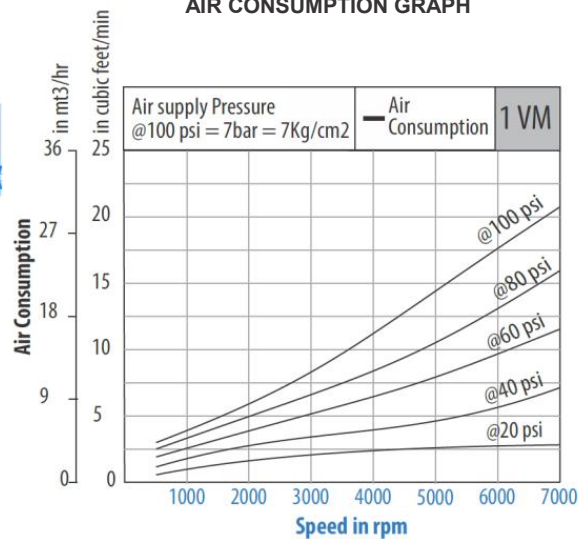

DIMENSIONAL DATA - NEMA FLANGE MOUNTING 1VM

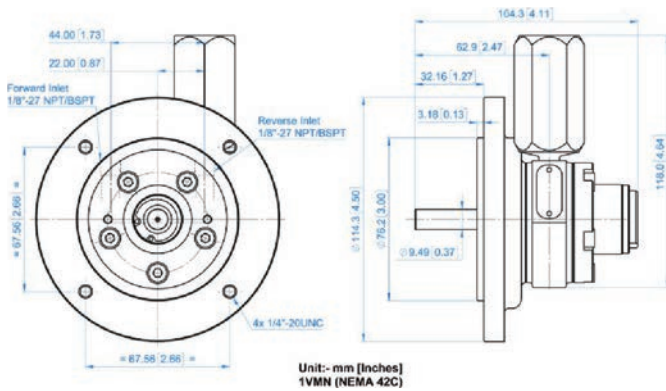

WEIGHTS & FINISH

Air Motor Type	Weight	Finish
Hub Mounting	1.0 kgs (2.2 lbs)	Silver
Foot Mounting	1.1 kgs (2.1 lbs)	Silver
Nema Mounting	1.7 kgs (3.7 lbs)	Silver

AIR MOTOR NOMENCLATURE

Size	Motor Type	Mounting	Lubricated or Lube-Free	Material of Construction	Explosion Proof	Threading on Inlet and Outlet	Direction of Rotation	No of Vanes
1	VM- Vane Type	L- Face Type	A- Lubricated	L - SG Iron	EX	R- NPT	C - Clockwise	4
2		S- Foot Type		S - SS		G - BSPT	A - Anticlockwise	6
4		T - Hub		A - Aluminum		P - BSPP	R - Reversible	8
6		D - IEC Flange Type	O - Lube Free					
8		N - NEMA Flange Type						
16								

MODEL NUMBERS

1VMT ALEX RR4 TE
1VMS ALEX RR4 TE
1VMN ALEX RR4 TE
1VMT ALEX GR4 TE
1VMS ALEX GR4TE
1VMN ALEX GR4 TE



II 2GD Ex h IIC T6 Gb
II 2GD Ex h IIIC T85° C Db