

TECHNICAL DATA

RELEASED:13/09/2024
 REVISED:
 REV: 00

2VM Ex PNEUMATIC VANE MOTOR

DIMENSIONAL DATA - FOOT MOUNTING 2VM

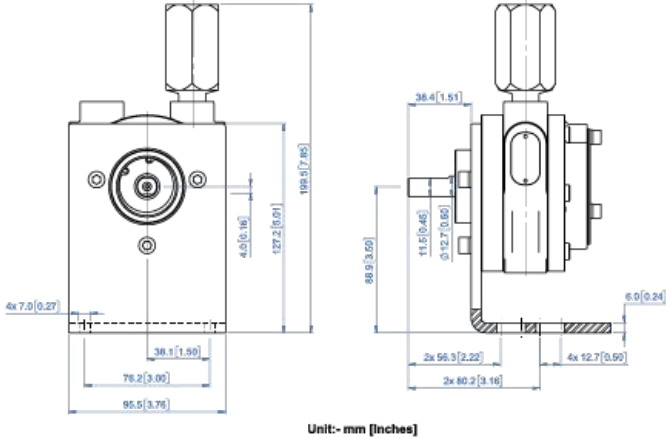

PERFORMANCE DATA

Max Output Power	0.68kW (0.91hp)
Speed at Max Power	3000 RPM
Maximum Torque	3.05Nm (26.99lb-In)
Air Consumption at Max Power	49.5m ³ /hr (30cfm)
Ambient Safe Operating Temperature	
• Non Explosive Zone	0°C to 120°C
• Explosive Zone	0°C to 40°C
Maximum Allowable Operating Speed In any Direction	4000 RPM
Working Pressure	7kg/cm ² (100 psi)

DIMENSIONAL DATA - HUB MOUNTING 2VM

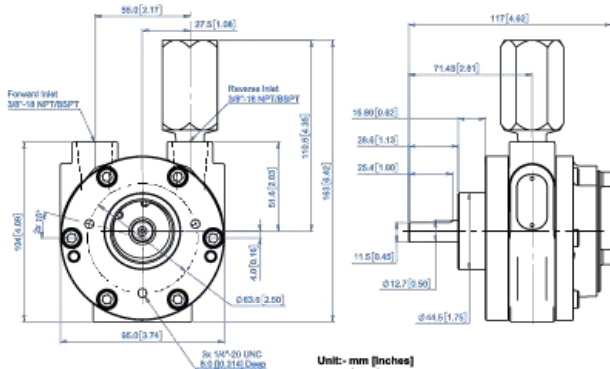

POWER & TORQUE GRAPH

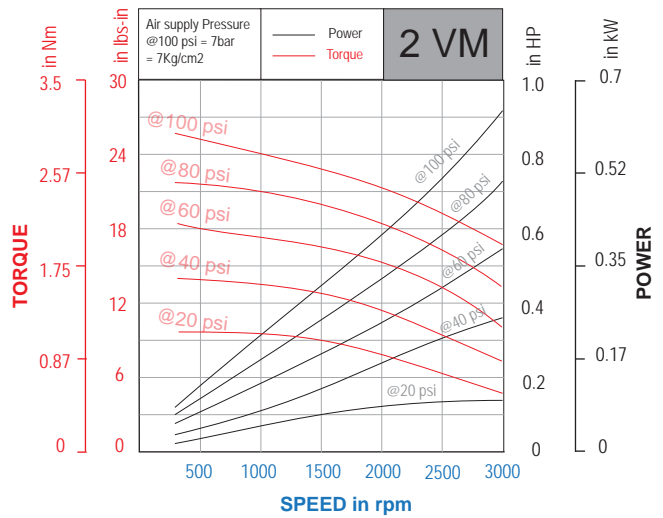

DIMENSIONAL DATA - NEMA FLANGE MOUNTING 2VM

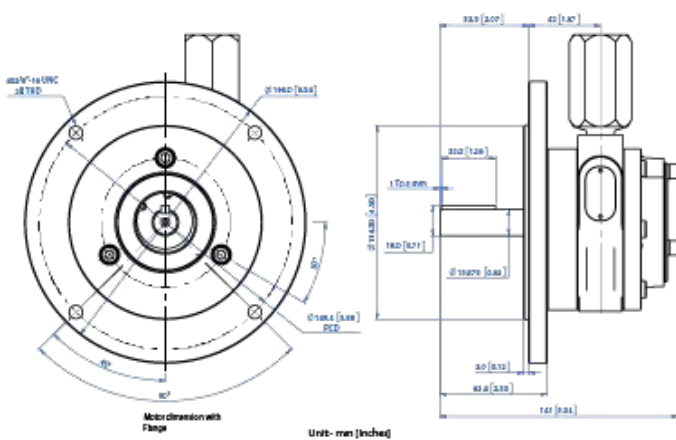

AIR CONSUMPTION GRAPH

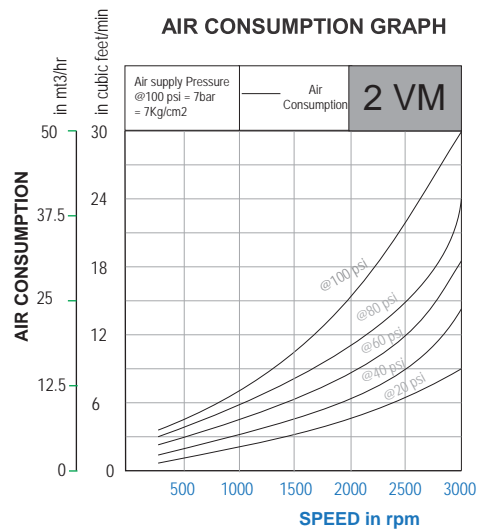

DIMENSIONAL DATA - IEC MOUNTING 2VM

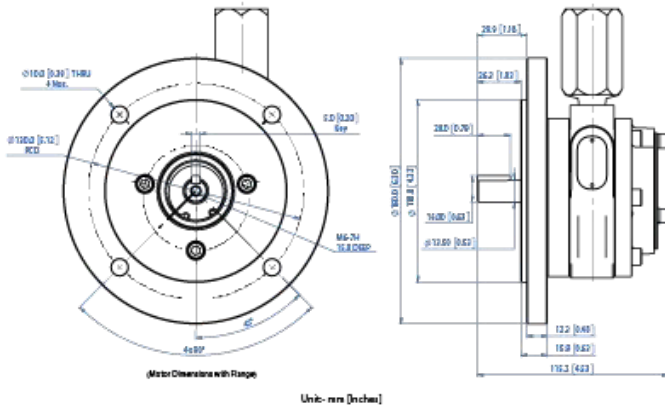

WEIGHTS & FINISH

Air Motor Type	Weight	Finish
Hub Mounting	3.1 kgs (8.1 lbs)	Silver
Foot Mounting	3.2 kgs (7.0 lbs)	Silver
IEC Mount	4.6 kgs (10.1 lbs)	Silver
NEMA Mount	4.6 kgs (10.1 lbs)	Silver

AIR MOTOR NOMENCLATURE

X	X	X	X	X	X	X	X	X
Size	Motor Type	Mounting	Lubricated or Lube-Free	Material of Construction	Explosion Proof	Threading on Inlet and Outlet	Direction of Rotation	No of Vanes
1	VM- Vane Type	L- Face Type	A- Lubricated O - Lube Free	L - SG Iron S - SS A - Aluminum	EX	R- NPT G - BSPT P - BSPP	C - Clockwise A - Anticlockwise R - Reversible	4 6 8
2		S- Foot Type						
4		T - Hub						
6		D - IEC Flange Type						
8		N - NEMA Flange Type						
16								

MODEL NUMBERS

2VMT ALEX RR4 TE	2VMT ALEX RR8 TE
2VMS ALEX RR4 TE	2VMS ALEX RR8 TE
2VMN ALEX RR4 TE	2VMN ALEX RR8 TE
2VMD ALEX RR4 TE	2VMD ALEX RR8 TE
2VMT ALEX GR4 TE	2VMT ALEX GR8 TE
2VMS ALEX GR4 TE	2VMS ALEX GR8 TE
2VMN ALEX GR4 TE	2VMN ALEX GR8 TE
2VMD ALEX GR4 TE	2VMD ALEX GR8 TE



II 2GD Ex h IIC T6 Gb
II 2GD Ex h IIIC T85°C Db